

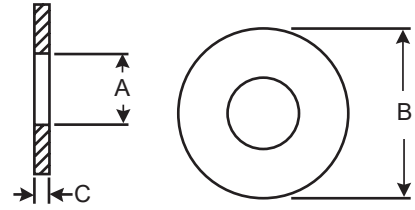

Quality Fasteners,
Delivered!®

Round Washer Identification Chart

Inch Sizes



Flat Washers

Nominal Washer Hole Size (Inches)	Pattern Type	A			B			C		C	
		Inside Diameter			Outside Diameter			Standard Thickness		Extra Thick	
		Basic	Tolerance		Basic	Tolerance		Tolerance		Tolerance	
			+	-		+	-	Max	Min	Max	Min
1/4"	SAE	0.281	0.015	0.005	0.625	0.015	0.005	0.065	0.055	0.090	0.110
1/4"	USS	0.312	0.015	0.005	0.734	0.015	0.007	0.065	0.055	0.090	0.110
5/16"	SAE	0.344	0.015	0.005	0.688	0.015	0.007	0.065	0.055	0.090	0.110
5/16"	USS	0.375	0.015	0.005	0.875	0.030	0.007	0.080	0.064	0.090	0.110
3/8"	SAE	0.406	0.015	0.005	0.812	0.015	0.007	0.065	0.055	0.110	0.126
3/8"	USS	0.438	0.015	0.005	1.000	0.030	0.007	0.080	0.064	0.110	0.126
7/16"	SAE	0.469	0.015	0.005	0.921	0.015	0.007	0.065	0.055	0.110	0.126
7/16"	USS	0.500	0.015	0.005	1.250	0.030	0.007	0.080	0.064	0.110	0.126
1/2"	SAE	0.531	0.015	0.005	1.062	0.030	0.007	0.116	0.100	0.156	0.188
1/2"	USS	0.562	0.015	0.005	1.375	0.030	0.007	0.116	0.100	0.156	0.188
9/16"	SAE	0.594	0.015	0.005	1.156	0.030	0.007	0.116	0.100	0.156	0.188
9/16"	USS	0.625	0.015	0.005	1.469	0.030	0.007	0.116	0.100	0.156	0.188
5/8"	SAE	0.656	0.030	0.007	1.312	0.030	0.007	0.138	0.122	0.170	0.195
5/8"	USS	0.688	0.030	0.007	1.750	0.030	0.007	0.138	0.122	0.170	0.195
3/4"	SAE	0.812	0.030	0.007	1.469	0.030	0.007	0.138	0.122	0.170	0.195
3/4"	USS	0.812	0.030	0.007	2.000	0.030	0.007	0.138	0.122	0.170	0.195
7/8"	SAE	0.938	0.030	0.007	1.750	0.030	0.007	0.152	0.136	0.235	0.265
7/8"	USS	0.938	0.030	0.007	2.250	0.030	0.007	0.160	0.136	0.235	0.265
1"	SAE	1.062	0.030	0.007	2.000	0.030	0.007	0.160	0.136	0.235	0.265
1"	USS	1.062	0.030	0.007	2.500	0.030	0.007	0.160	0.136	0.235	0.265

Fender Washers

Nominal Washer Hole Size (Inches)	A			B			C		C	
	Inside Diameter			Outside Diameter			1/16" Standard Thick		1/8" Extra Thick	
	Basic	Tolerance		Basic	Tolerance		Tolerance		Tolerance	
		+	-		+	-	Max	Min	Max	Min
3/16"	0.219	0.015	0.005	1.000	0.015	0.005	0.080	0.047	0.132	0.108
1/4"	0.281	0.015	0.005	1.000	0.015	0.005	0.080	0.047	0.132	0.108
	0.281	0.015	0.005	1.250	0.015	0.005	0.080	0.047	0.132	0.108
	0.281	0.015	0.005	1.500	0.015	0.005	0.080	0.047	0.132	0.108
5/16"	0.343	0.015	0.005	1.250	0.015	0.007	0.080	0.047	0.132	0.108
	0.343	0.015	0.005	1.500	0.015	0.007	0.080	0.047	0.132	0.108
1/4"	0.406	0.015	0.005	1.250	0.015	0.007	0.080	0.047	0.132	0.108
	0.406	0.015	0.005	1.500	0.015	0.007	0.080	0.047	0.132	0.108
	0.406	0.015	0.005	2.000	0.015	0.007	0.080	0.047	0.132	0.108
1/2"	0.531	0.015	0.005	2.000	0.015	0.007	0.080	0.047	0.132	0.108



Quality Fasteners,
Delivered!®

Round Washer Identification Chart

Metric Sizes

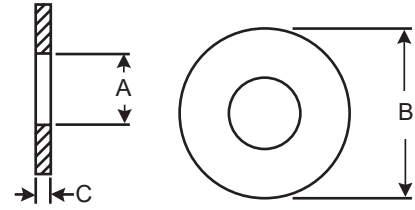

Flat Washers (Din 125A)

Nominal Washer Hole Size (MM)	A		B		C	
	Inside Diameter		Outside Diameter		Thickness	
	Tolerance		Tolerance		Tolerance	
	Max	Min	Max	Min	Max	Min
M3 (3MM)	3.80	3.32	7.00	6.64	0.55	0.45
M4 (4MM)	4.48	4.30	9.00	8.64	0.90	0.70
M5 (5MM)	5.48	5.30	10.00	9.64	1.10	0.90
M6 (6MM)	6.62	6.40	12.00	11.57	1.80	1.40
M8 (8MM)	8.62	8.40	16.00	15.57	1.80	1.40
M10 (10MM)	10.77	10.50	20.00	19.48	2.20	1.80
M12 (12MM)	13.27	13.00	24.00	23.48	2.70	2.30
M14 (14MM)	15.27	15.00	28.00	27.48	2.70	2.30
M16 (16MM)	17.27	17.00	30.00	29.48	3.30	2.70
M18 (18MM)	19.33	19.00	34.00	33.38	3.30	2.70
M20 (20MM)	21.33	21.00	37.00	36.38	3.30	2.70

Fender Washers (Din 127)

Nominal Washer Hole Size (MM)	A		B		C	
	Inside Diameter		Outside Diameter		Thickness	
	Tolerance		Tolerance		Tolerance	
	Max	Min	Max	Min	Max	Min
M3 (3MM)	3.38	3.20	9.00	8.64	0.90	0.70
M4 (4MM)	4.48	4.30	12.00	11.57	1.10	0.90
M5 (5MM)	5.48	5.30	15.00	14.57	1.40	1.00
M6 (6MM)	6.62	6.40	18.00	17.57	1.80	1.40
M8 (8MM)	8.62	8.40	24.00	23.48	2.20	1.80
M10 (10MM)	10.77	10.50	30.00	29.48	2.70	2.30
M12 (12MM)	13.27	13.00	37.00	36.38	3.30	2.70
M16 (16MM)	17.27	17.00	50.00	49.38	3.30	2.70